

Cellphone entry phone

Answer visitors at your house or company from wherever you are with our cellphone entry phone. Visitors are connected instantly via a connection between a SIM card in the entry phone and your mobile phone.

Through a simple app you can check reception, program up to 4 cellphones and set the ringing time. The first programming happens in our workplace. For this we need an active SIM card without PIN code, without roaming and without voicemail.

The standard answering time is 20 sec., but is expendable up to 30 sec.

ATTENTION ⚠: Without decent reception it is advised to look for another solution. Be sure to test the reception of the SIM.

No voicemail can be set up during answering time. Only the last programmed cellphone can set up one.

USE

Answering a call

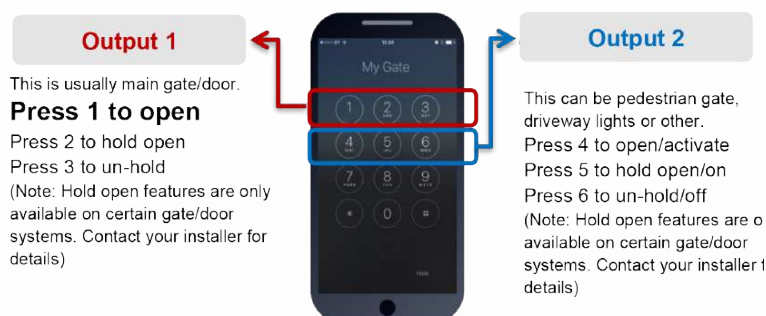
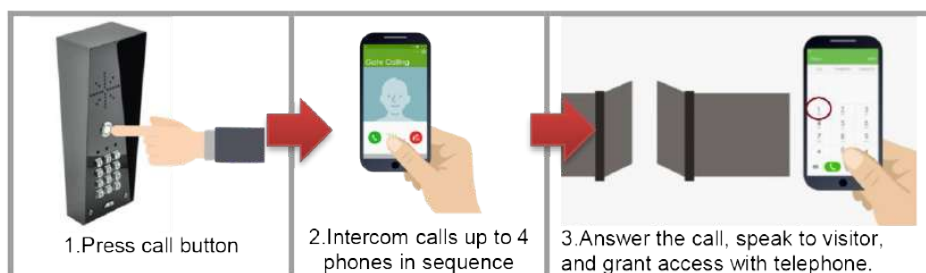

Operating with a call



The device has the capacity of 100 authorized users. They can open the entrance by calling the entry phone (output 1), but can't answer visitors at the entrance themselves.

When the device recognises you as user, it opens the door or gate and finally rejects the call. By rejecting the call it will stay free.

Use of the app

You can use the free Cellcom Prime app on Android phones and iPhones. Look for the icon below or scan the QR code.

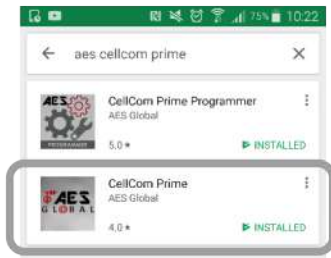

1. Install + launch the app, & accept all permissions. Press SETTINGS.



2. Select your intercom type 2G/3G or 4G (this changes how the Proximity part works)

3. Select Single Intercom if you have only one intercom and one entrance. Select two intercoms if you have 2 gate entrances with intercoms fitted. You can select different background colour for dual intercom operation so that you know which intercom you are controlling.

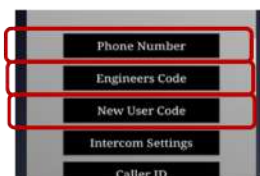

4. Store the phone number of the intercom SIM card in the phone number screen.



5. If the installer has changed the engineers code, they can enter it here.



6. If the user code has been changed, enter it here.

Homescreen

